

ACCESORIOS

Utilizar solo productos que cumplan con la normativa CE y hayan estado fabricados expresamente para la escalada o el alpinismo. Seguir atentamente las instrucciones de uso. Recomendamos solo el uso de mosquetones de al menos 10mm de diámetro para anclarse el puño al arnés y para asegurar la cuerda al puño.

EN567 : norma europea que rige este tipo de artículos.

Fixe: fabricante

Organismo notificado que interviene en el examen de tipo: CETE APAVE SUDEUROPE, BP 193 13322 Marseille Cedex, 16 – France, n. 0082

EN GENERAL INFORMATION

It is quite dangerous to practice activities in a vertical environment. You need to learn properly how to use the product this instructions refers to. Read and follow this instructions. This product is specially designed to use climbing, mountaineering or doing vertical works and it doesn't release the user from his responsibilities. Fixe will not recognize any responsibility in case of death or injuries due to a wrong use, repairing, assembly or modification of this product done by a non-authorized person. You assume he responsibility for any death or injury caused by a wrong use of our products, whatever the way these are used. If you are not ready to assume this responsibility, do not use these products. Both, the manufacturer and the seller, decline all kind of responsibilities in case of wrong use or manipulation of this product. In these cases, the risk and responsibilities are for the user. Moreover, the product has to be examined accurately before each use in order to look for possible signs indicating its bad state. Only trained or experienced people can use this product. This instructions are to be only help on the correct use of this product. As it is impossible to list here all the possible wrong applications of this product, these instructions cannot supply, in any case, the experience and responsibility of the user.

WORKING

The ascender «Capitan» is a mechanism that allows you to go up fixed ropes thanks to some teeth that sink into the rope when the weight hangs down the ascender. When the weight does not hang, it is possible to slip the mechanism up the rope. There are two specific models: one for the right hand and one for the left one.

PRODUCT DESCRIPTION (figure 1)

- 1-Hole for chest sling (1 out of 2)
- 2-Hole for accessory cord
- 3-Trigger to open the mechanism
- 4-Handle
- 5-Hole for maillon and pedal for the ascender
- 6-Hole for security carabiner and chest sling (2 out of 2)
- 7-Direction of use
- 8-Rope diameter
- 9-Manufacturer logo
- 10-Mechanism for anchoring to the rope
- 11-Conformity CE logo
- 12-Instructions pictogram
- 13-Hole for anchoring to the harness

USE

To place the ascender to the rope (figure 2)

- Look for the direction arrow of the ascender in order to place it correctly with the rope.
- Open the blocking system pushing the trigger down and back.

-Place the rope (diameter 8 to 12mm) through the channel specially for it and in the same direction than the rope.

-Unblock the trigger

-Connect a security carabiner to hole n. 6

To anchor oneself to the ascender

-Anchor the ascender to your harness with a sling and a security carabiner on the hole n. 13

-Use hole n. 5 with a maillon, to connect the pedal

-Pass a sling among holes 5 and 6 to use the ascender as a chest one. (figure 3)

Progression (figure 4)

-Slip the ascender up the rope with the handle always in a parallel position with the rope. Use the carabiners to get this.

-To go down a few meters, push the blocking mechanism from the upper part with your finger.

To take the rope out

-Once anchored to another point, you can disengage the harness from the ascender.

-Take the security carabiner out of hole n.6

-Open de blocking mechanism pushing the trigger and taking the rope out of the channel

STORING AND MAINTENANCE

Use and maintain our products between -50°C and +50°C. The product has to be stored in a non compressed way, in an aired place far from sunlight, extreme temperatures, marine environments, heating sources, humidity and corrosive and chemical products.

SECURITY CONTROL

Inspection periodically the ascender. Check for cracks, deformities or corrosion signs. Make attention to the channel for the rope. Check that the blocking system has all the teeth and their state. Check that trigger is not broken and can be opened easily. Check that the ascender slips through the rope and blocks it correctly. Check the state of the screws. Clean and oil the screws and the spring if necessary. Check that the edges have not been sharpened and act as knives.

DURATION

The duration of the ascender depends on the use of the product. It is difficult to talk about a determinate duration , as it depends on the use and the environment. Some environments accelerates the degradation of the products, as marine, sandy and chemical environments. Generally, the life of an ascender can be about 5 years.

ACCESSORIES

Use only CE approved products, manufactured for climbing and mountaineering. Read carefully the instructions for use. We recommend to use 10mm diameter carabiners at least.

EN 567: European Standard used for this kind of products.

Fixe: Manufacturer

Notified body that takes part on the exam: CETE APAVE SUDEUROPE, BP 193 13322 Marseille Cedex 16 – France, n. 0082



Fixe Climbing SL
C. Jeroni Guixà, 1
08580 Sant Quirze de Besora
Barcelona – Espanya



figura 1



figura 3

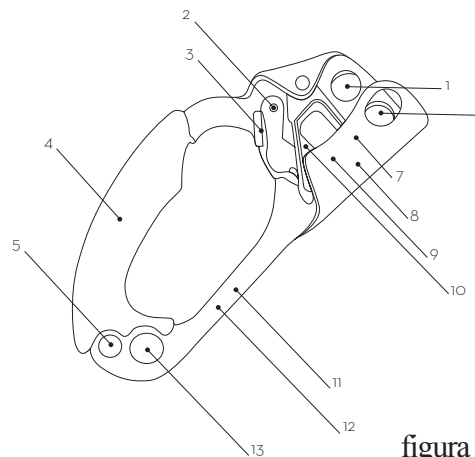

figura 4

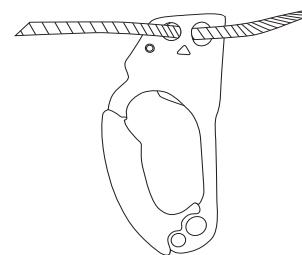

figura 2

TARGETA D'INSPECCIÓ, TARJETA DE INSPECCIÓN, INSPECTION CARD	
Producte, Producto, Product:	
Model:	
Marca, Trademark:	
Fabricat per, fabricado por, Manufactured by:	Fixe Climbing SL C. Jeroni Guixà, 1 08580 Sant Quirze de Besora Barcelona – Espanya
Any de fabricació, Año de fabricación, Manufactured on:	
Data de compra, Fecha de compra, Shopping date:	
Posada en servei, Puesta en servicio, First use:	
Nom usuari, Nombre usuario, User's name:	
Comentaris, Comentarios, Commentaries:	

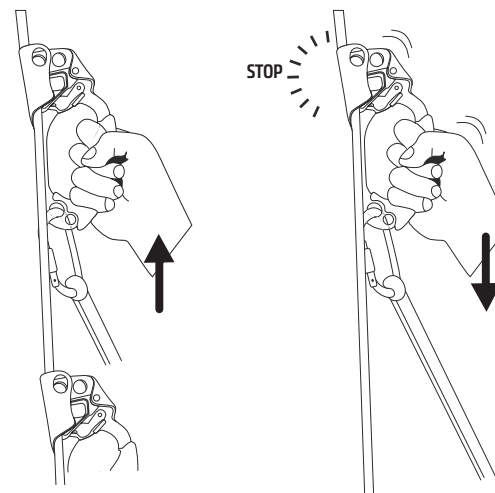
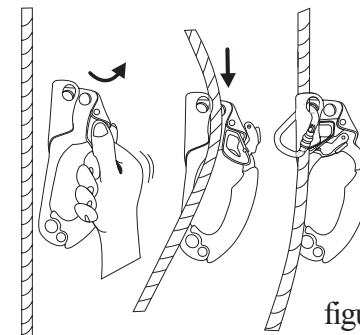